

THIS DRAWING CONTAINS INFORMATION PROPRIETARY TO RF INDUSTRIES.
 ANY UNAUTHORIZED USE OF THIS DRAWING IS EXPRESSLY PROHIBITED
 WITHOUT WRITTEN PERMISSION FROM RF INDUSTRIES.
 ANY VIOLATION IS PUNISHABLE UNDER U.S. COPYRIGHT LAWS.

ALL DIMENSIONS ARE REFERENCE ONLY

PART NO.

RSA-3458

REV	DESCRIPTION	DWN	DATE	APPROVED
B	CHANGE PART # FROM RSA-2380 TO RSA-3458	WMD	1/3/94	C. JONES
C	UPDATE	KMM	6/15/95	R. RICE
D	CHANGE MATERIALS	KMM	10/5/96	R. RICE
E	CHANGE SPECS, FORMAT & DWG # 8185	GGG	3/11/02	JDMc

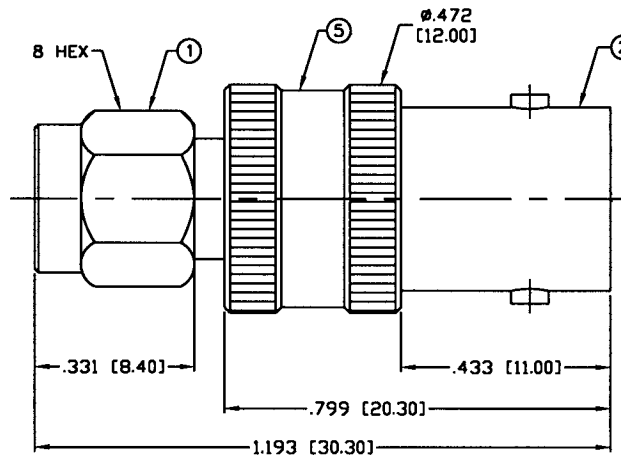

SPECIFICATIONS:

IMPEDANCE: 50 Ohms
 FREQUENCY RANGE: 0-12.4 GHz
 WORKING VOLTAGE: 500 V rms Max. @ Sea Level
 INSULATION RESISTANCE: 5k M Ohms min.
 TEMPERATURE RANGE: -65°C TO 85°C

1	SHELL	1	BRASS	NICKEL, 100 μ "	008974	
2	BNC BODY	1	BRASS	NICKEL, 100 μ "		
3	RETAINING RING	1	Be-Cu	---		
4	GASKET	1	SILICONE	---		
5	BODY	1	BRASS	NICKEL, 100 μ "		
6	PIN	1	PHOS BRONZE	GOLD, 3 μ "		
7	INSULATOR	1	PTFE	---		
8	INSULATOR	1	PTFE	---		
9						
10						
11						
12						
13						
14						
#	DESCRIPTION	QTY	MATERIAL	FINISH	APPROVALS	DATE

DRAWN
G. GALLEGOS 3/11/02
 CHECKED
JDMc 3-11-02
 ORJ DRAWN
K. MAXWELL 8/20/93

UNLESS OTHERWISE SPECIFIED:
 1. REMOVE ALL BURRS
 2. BREAK ALL CORNERS & EDGES .005 R. MAX.
 3. CHAMFER 1ST & LAST THREADS 45°
 4. SURFACE ROUGHNESS 63 FINISH MIL-STD-10
 5. DIAMETERS ON COMMON CENTERS TO BE CONCENTRIC WITHIN .002 T.I.R.
 6. ALL DIMENSIONS ARE AFTER PLATING.

DIMENSIONS ARE IN INCHES AND [MILLIMETERS]
 UNLESS OTHERWISE NOTED TOLERANCES ARE:
 DECIMALS DIAMETER
 .xxx±.003 [.08] .xxx±.001 [.03]
 .xx±.005 [.13] .xx±.003 [.08]

RFconnectors
 DIVISION OF RF INDUSTRIES, LTD.

EPCOM syscom
 1630 Paisano Dr.
 El Paso, Tx 79901
 Ph (915) 533-5119
 www.epcom.net

SMA PLUG TO BNC JACK

ADAPTER

SIZE A	CABLE GROUP N/A	DWG NO. RSA-3458	REV E
SCALE: NTS		CAD FILE OUTLINE	SHEET 1 OF 1